

6020-2Z Deep groove ball bearings

bearings

- Popular item
- SKF Explorer

Deep groove ball bearings

Bearing data

[Tolerances](#),

Normal (metric), P6, P5, Normal (inch),

[Radial internal clearance](#),

Matched bearing pairs, Stainless steel
d < 10 mm, Other bearings

Bearing interfaces

[Seat tolerances for standard conditions](#),

[Tolerances and resultant fits](#)

Technical specification

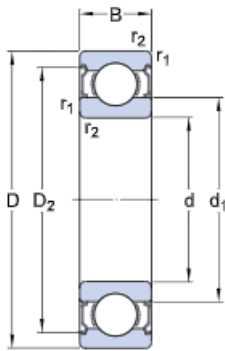

DIMENSIONS

d	100 mm	Bore diameter
D	150 mm	Outside diameter
B	24 mm	Width
d ₁	≈ 115.95 mm	Shoulder diameter
D ₂	≈ 138.3 mm	Recess diameter
r _{1,2}	min. 1.5 mm	Chamfer dimension

ABUTMENT DIMENSIONS

d _c min.	107 mm	Diameter of shaft abutment
d _c max.	115.9 mm	Diameter of shaft abutment
D _i max.	143 mm	Diameter of housing abutment
r _a max.	1.5 mm	Radius of shaft or housing fillet

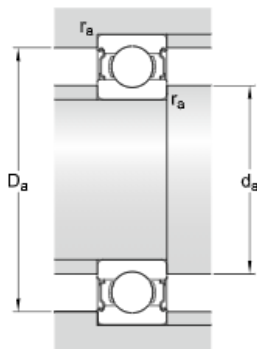

CALCULATION DATA

C	63.7 kN	Basic dynamic load rating
C ₀	54 kN	Basic static load rating
P _u	2.04 kN	Fatigue load limit
	9 500 r/min	Reference speed
	4 500 r/min	Limiting speed
k _r	0.025	Minimum load factor
f ₀	15.9	Calculation factor

MASS

	1.32 kg	Mass bearing
--	---------	--------------

TOLERANCE CLASS

P6	Dimensional tolerances
Normal	Radial run-out